

ALL IDEAS, RESOURCES, ARRANGEMENTS AND PLANS INDICATED OR REPRESENTED BY THIS DRAWING ARE OWNED BY AND THE PROPERTY OF CVEAS OR CONSULTANTS, AND WERE CREATED, DEVELOPED FOR USE ON AND IN CONNECTION WITH THE SPECIFIED PROJECT. NONE OF SUCH IDEAS, RESOURCES, ARRANGEMENTS OR PLANS SHALL BE USED BY OR DISCLOSED TO ANY PERSON, FIRM OR CORPORATION FOR ANY PURPOSE WHATSOEVER WITHOUT THE WRITTEN PERMISSION OF CVEAS. ANY REPRODUCTION OR USE THEREOF IS PERMISSIBLE WITHOUT THE CONSENT OF CVEAS.

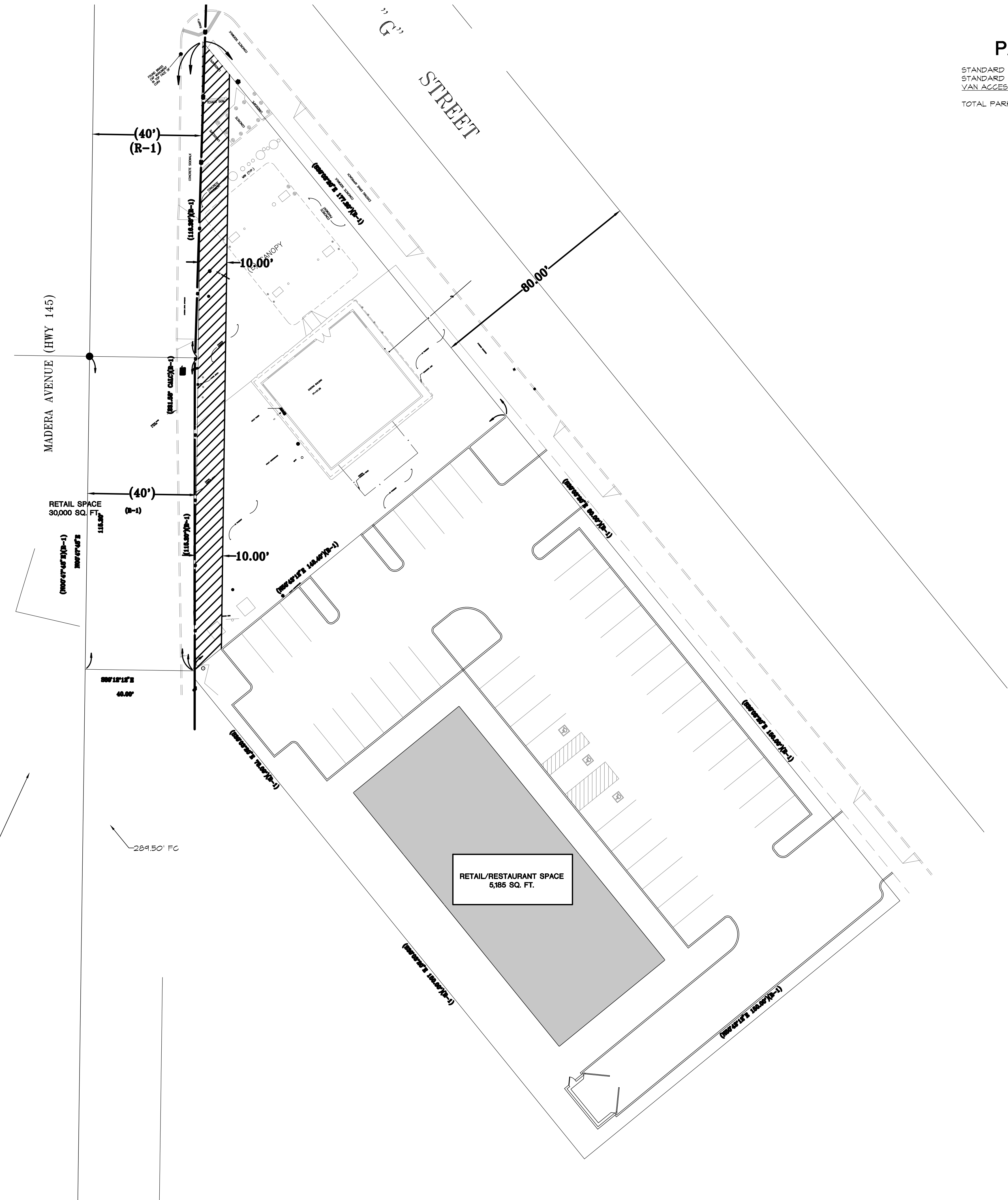

PARKING CALCULATIONS

STANDARD PARKING STALLS: 41 PARKING STALLS;
 STANDARD ACCESSIBLE PARKING STALLS: 2 PARKING STALLS;
 VAN ACCESSIBLE PARKING STALLS: 1 PARKING STALL
 TOTAL PARKING STALLS PROVIDED: 44 PARKING STALLS

CVEAS
CENTRAL VALLEY
 ENGINEERING & SURVEYING, INC.
 2132 HIGH STREET Tel: (559) 801-8811
 SELMA, CA 93662 Fax: (559) 801-8815
 WWW.CVEAS.COM Email: info@cveas.com

PROPOSED LAYOUT FOR:
CITY OF MADERA
PROPOSED RETAIL/RESTAURANT
AT S. MADERA AVE. & S. G ST.



Revisions:	Date:
▲	
▲	
▲	
▲	

PROPOSED EXHIBIT A

CVEAS Job #:	XXXX
Current Release Date:	XXX
Planning Submittal:	00/00/00
Plan Check Submittal:	00/00/00
Drawn By:	XXX
Checked By:	XXX
Scale:	AS NOTED

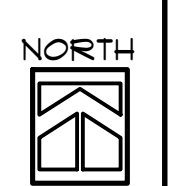

PROPOSED RETAIL/RESTAURANT SITE PLAN

SCALE: 1"=20'-0"

A1.1

CIVIL ENGINEERING • LAND SURVEYING • CONSULTING • STRUCTURAL DESIGN • ARCHITECTURAL DRAFTING • COMMERCIAL & RESIDENTIAL BUILDING DESIGN • PLANNING & PROJECT MANAGEMENT